

# TSUNYOW

WHERE KITSELAS CONNECTS

JUNE 24, 2022

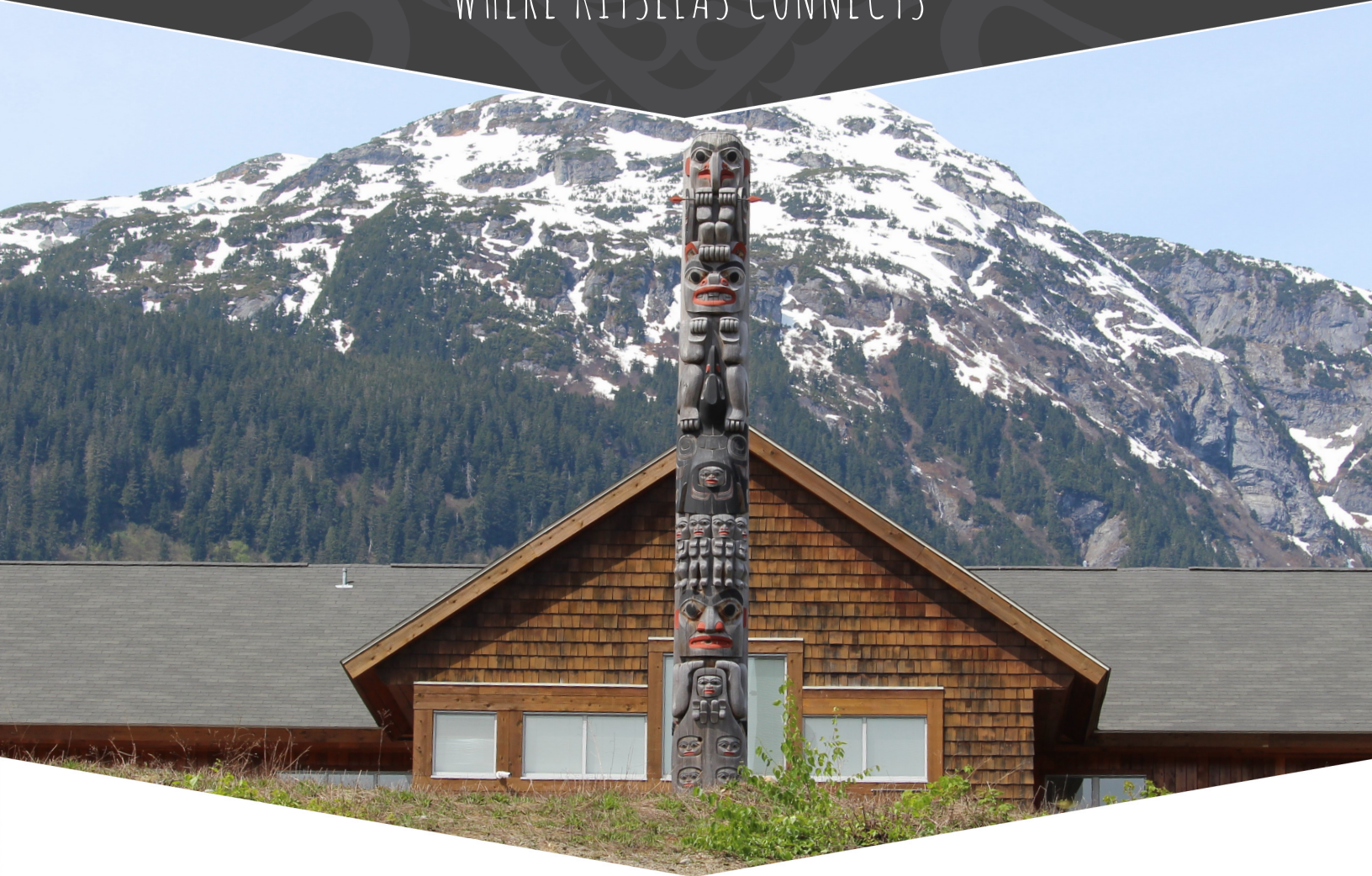

A Bi-Weekly newsletter from the



Kitselas Band Council & Administration

## IN THIS ISSUE

- |   |   |   |  |
|---|---|---|--|
| 1 | In this issue index   | 7 | Kitselas Culture Camp 2022 Application |
| 2 | Council News  | 8 | Bioenergy for Kitselas                 |
| 3 | National Indigenous Peoples Day Recap   | 9 | Kitselas Fisheries App. Direction      |
| 4 | K5T Open House, Summer Youth Job<br>Kitselas Marine Plan Community Engagement,<br>July Youth Empowerment Calendar |   |  |
| 5 | Kitselas Culture Camp 2022  |   |  |
| 6 | Kitselas Culture Camp 2022 pg.2   |   |  |

June 2022



# COUNCIL NEWS

## Council Meeting Agenda Items

*Draft agenda items include:*

- i) RBC Dominion Securities Draft Investment Policy Statement
- ii) IR#4 final survey
- iii) Annual Tax Law Expenditure
- iv) RCMP Letter of Expectations
- v) Strategic Priorities Terrace Detachment
- vi) Appointment of auditor
- vii) Geo Thermal update



## UPCOMING COUNCIL MEETINGS

2022

⇒ Tues June 28, 2022  
*Queensway Boardroom*



## National Indigenous Peoples Day Celebration and NIFCSS Lighthouse Blessing

The Kitselas NIPD Celebration 2022, was co-hosted by Kitselas Health and NIFCSS. NIFCSS had their open house for the community Lighthouse which will be available for use by various Kitselas groups. The Lighthouse is run by NIFCSS and they have a Youth Empowerment worker, Miranda Gray that will be there full time. And there will also be a family support worker, as well as visiting social worker, clinician as needed or when scheduled.

These were the fun activities that happened,

- Bouncy Castles
- Cedar Weaving by Stella Wright
- Kitselas Dancers performed
- Door Prizes provided
- Gifts given (fold up chairs, umbrellas)
- Bags provided with a cup, and notebook



Please Join us to  
Celebrate



**K5T's**  
Open House  
&  
Clubhouse Blessing

**June 28 10am-1:30pm**  
4404 Queensway Drive  
Blessing at 11:30  
Lunch and refreshments served  
Door prizes

**WE ARE  
HIRING!**

**Kitselas Summer  
Students**

- 15 years and older
- Returning to school
- Cut off June 29
- Start July 4th to Aug 19
- First come first serve
- Must have SIN #

Apply by email to  
[Sierra@Kitselatraining.com](mailto:Sierra@Kitselatraining.com)

Questions call 250.641.4229.



**What is the Kitselas Marine Plan?**  
It is a strategic document to guide marine resource management in Kitselas marine Territory.



**Why does it need to be updated?**  
The current plan was drafted in 2010. As with any plan, it is best practice to update as we learn, and as the context we are working in changes over time and the need to fill in any gaps of the current plan.

Tuesday July 5, 2022	Wednesday July 6, 2022
<b>12:00 – 2:00pm</b> Elders luncheon provided Kitselas Hall	<b>5:00 – 7:00pm</b> Community Dinner provided Kitselas Hall

What is the engagement sessions about?

- Provide an update on the Draft Marine Plan
- Confirm the vision
- Review the guiding principles
- key issues and concerns
- Next steps - spatial planning in the marine Territory



If you have questions or if you would like more information contact:  
Nina Kafoury-Nichols at 1- 604-655-6775 or [nina.mk.nichols@gmail.com](mailto:nina.mk.nichols@gmail.com)

**July**

**2022**

**Kitselas Youth & Right to Play**

KITSELAS LEADERSHIP CULTURE CAMP AGES 12+ - JULY 4TH TO JULY 8TH  
LIMITED SEATING FOR CULTURE CAMP-KITSELAS YOUTH ONLY.



\*\*\*\*\* ANY CHANGES WILL BE ANNOUNCED \*\*\*\*\*

Sunday	Monday	Tuesday	Wednesday	Thursday	Friday	Saturday
					<b>Canada Day No Work.</b>	
Basketball @ Sportsplex (Hidber Arena) 4pm-5pm	ASP: 3:30-5:00 Baking Drop-in 7-9 Leadership Camp Ages 12+ Kitselas Treaty	ASP: 3:30-5:00 Crafting Boys Group 7pm-9pm Leadership Camp Ages 12+ Kitselas Treaty	ASP: 3:30-5:00 Walk Wed. Drop-in 7pm-9pm Leadership Camp Ages 12+ Kitselas Treaty	ASP: 3:30-5:00 Active Play Girls Group 6pm-8pm Leadership Camp Ages 12+ Kitselas Treaty	<b>No Program Administration day Prep for Culture Camp.</b>	
Basketball @ Sportsplex (Hidber Arena) 4pm-5pm	Culture Camp Ages 6 & up for Registered Kitselas Youth.	Culture Camp Ages 6 & up for Registered Kitselas Youth.	Culture Camp Ages 6 & up for Registered Kitselas Youth.	Culture Camp Ages 6 & up for Registered Kitselas Youth.	Culture Camp Ages 6 & up for Registered Kitselas Youth.	
Basketball @ Sportsplex (Hidber Arena) 4pm-5pm	Culture Camp Ages 6 & up for Registered Kitselas Youth.	Culture Camp Ages 6 & up for Registered Kitselas Youth.	Culture Camp Ages 6 & up for Registered Kitselas Youth.	Culture Camp Ages 6 & up for Registered Kitselas Youth.	Culture Camp Ages 6 & up for Registered Kitselas Youth.	
Basketball @ Sportsplex (Hidber Arena) 4pm-5pm	Activities TBA	Activities TBA	Activities TBA	Activities TBA	Activities TBA	
Basketball @ Sportsplex (Hidber Arena) 4pm-5pm						





## Kitselas Culture Camp 2022

### Parent\Guardian Waiver.

- Every effort for care and attention will be given to the well-being and safety of participants.
- All Participants will be supervised at all times in the program.
- High standard of conduct will be expected at all times from participants.
- Any unacceptable behavior will be dealt with appropriately by staff. If the severity of the misbehavior calls for it, violators will be dismissed from the program.
- Please read **"Terms and Conditions of Kitselas Youth Programs"** below.
- Program staff can not be held responsible for any accidents that may occur. In consideration of the Kitselas youth programs accepting the application.

### Kitselas Terms and Conditions of the Kitselas Youth Programs.

#### Ground Rules:

1. No Physical Contact. This includes: Hitting, Punching, Wrestling, Kicking, ETC.
  2. No verbal fighting. This includes swearing, name calling, teasing.
  3. Listen to Staff\Volunteers at all times.
  4. No Bullying. This includes no spitting, teasing, physical or verbal violence, name calling or sexual comments or behavior.
  5. No gossiping
  6. respect the personal space & property of others.
  7. Clean up after yourselves (garbage to bins, clean spills, put supplies back where they belong)
- Covid: we will supply hand cleaning stations\ Hand sanitizer & No attending if you or anyone in home is feeling unwell.

- Kitselas Youth Programs are a **NO TOLERANCE ZONE FOR DRUGS, ALCOHOL, CIGARETTES, VAPES AND WEAPONS**
- **Medical Emergency:** In the event of an emergency, the Kitselas staff may administrate the use of First-Aid treatment if necessary, and in case of medical emergency, permission is granted to the physician selected by supervisors to hospitalize and secure proper treatment for your child(ren) named on registration form. Every effort will be made to contact Parents or Guardians before such action. Kitselas staff also reserve the right to call for an ambulance if deemed necessary. You also acknowledge that you must assume total responsibility for ALL medical coverage, accidental insurance and personal injury, or any other loss or damage.

### Program Closures

- When youth are in a program they are supervised by staff and volunteers however, we cannot hold youth against their will, so in the event they choose to leave our programs and or property we cannot be held liable.
- Staff will encourage youth to inform parents that they are leaving the program and property
- Youth are required to Sign in and out for emergency reasons.
- Kitselas reserves the right to close programs due to unforeseen circumstances which may include but not limited to; staff shortage, emergency situations or inclement weather. incase of closure, staff will make an announcement .

I release the Kitselas Band employees and\or Volunteers; from any or all claims, damages or cause of action out of those participating in the program, and I understand and accept all terms and conditions of the Kitselas YOUTH Programs.

Parent\Guardian Name: \_\_\_\_\_

Signature: \_\_\_\_\_

Signed this \_\_\_\_\_ day of \_\_\_\_\_, 20\_\_.



**PARTICIPANT ONE**

Participant's Full Name: \_\_\_\_\_

Participant's Birth Date: \_\_\_\_\_ Participant's Gender: \_\_\_\_\_

Participant's Health Card Number: \_\_\_\_\_

Special Medical Concerns/dietary restrictions: \_\_\_\_\_

T-Shirt Size: \_\_\_\_\_

☐ **YES** I consent that photographs or video taken at the Youth Program may be used for purposes as described above

☐ **NO** I do not want any photographs or video taken at the Youth Program to be used for purposes as described above
**PARTICIPANT TWO**

Participant's Full Name: \_\_\_\_\_

Participant's Birth Date: \_\_\_\_\_ Participant's Gender: \_\_\_\_\_

Participant's Health Card Number: \_\_\_\_\_

Special Medical Concerns/dietary restrictions: \_\_\_\_\_

T-Shirt Size: \_\_\_\_\_

☐ **YES** I consent that photographs or video taken at the Youth Program may be used for purposes as described above

☐ **NO** I do not want any photographs or video taken at the Youth Program to be used for purposes as described above
**MAIN CONTACT**

Parent/Guardian Full Name: \_\_\_\_\_ Phone Number: \_\_\_\_\_

Address: \_\_\_\_\_

Parent/Guardian Email Address: \_\_\_\_\_

**SECONDARY CONTACT**

Full Name: \_\_\_\_\_ Phone Number: \_\_\_\_\_

Address: \_\_\_\_\_

Email Address: \_\_\_\_\_

Relationship to participant(s): \_\_\_\_\_

By signing below, participant (or participant's parent or legal guardian, if participant is under the age of 18) agrees that participant may participate in the Youth program and acknowledges having carefully read and understood this Form, and consents and agrees to its contents, including the Participant Waiver of Right and Release.

Participant Signature 1(if 18+): \_\_\_\_\_

Participant Signature 2(if 18+): \_\_\_\_\_

**Parent/Guardian Signature (must be parent/guardian of each participant named above):**

Date: \_\_\_\_\_

# Bioenergy for Kitselas



## What is Bioenergy?

**Bioenergy** uses biomass to produce energy.



**Biomass** is material that comes from plants.

For Kitselas, we are looking into...

**burning**



**wood waste from logging**

**to make heat and electricity**



**for houses and administration buildings at Gitaus**

To learn more visit the project webpage at:

<https://kitselas.com/.../housing/bioenergy-for-kitselas-2/>

*The project is funded by Strategic Partnerships Initiative's Northern and Remote Forests Biomass Initiative administered by the Natural Resources Canada's Indigenous Forestry Initiative Program.*





## Kitselas Fisheries App Directions

1. Scan QR Code or go to [fish.kitselas.com](https://fish.kitselas.com) – to scan point phone camera at code



2. Register on the app – band membership number is needed to do this

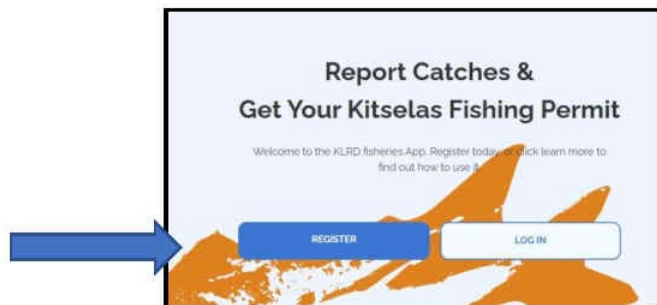

3. Apply for yearly food fish permit – band membership number is needed to do this

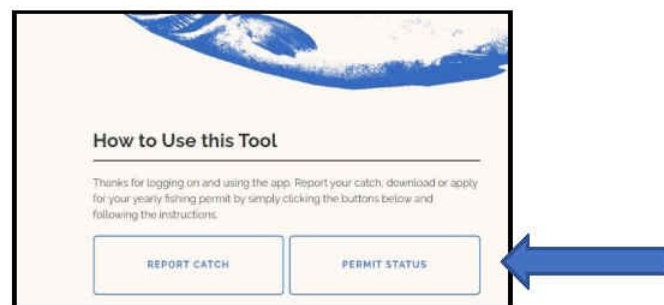

4. Download permit once administration has accepted your application

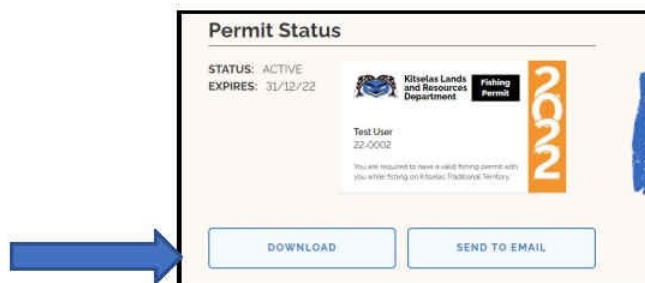

JUNE 24, 2022



## KITSELAS CONNECTS

Is put together by the Kitselas Communications Department.

Please email [communications@kitselas.com](mailto:communications@kitselas.com) with any info - events, news, fundraisers, photos, etc. - that you would like to share with the community.

Deadline for submissions is Tuesday.

Call 250-635-5084 Ext. 4071 with any questions

### KITSELAS ADMINISTRATION

2225 Gitaus Road, Terrace, BC V8G 0A9  
Phone: 250-635-5084 Fax: 250-635-5335

### Office Hours

Monday to Friday 8:30am-4pm  
Closed for lunch 12-12:30pm

**[WWW.KITSELAS.COM](http://WWW.KITSELAS.COM)**